

NOTES:

* DOORS & HARDWARE WILL BE DESIGNED & MANUFACTURED & INSTALLED ACCORDING TO STANDARDS ESTABLISHED BY THE DOOR ACCESS SYSTEMS MANUFACTURING ASSOCIATION (DASMA).

* AN INSIDE SLIDE LOCK SHOULD BE MOUNTED ON END STILE APPROXIMATELY 31" FROM BOTTOM OF DOOR ON THE INTERIOR LEFT.

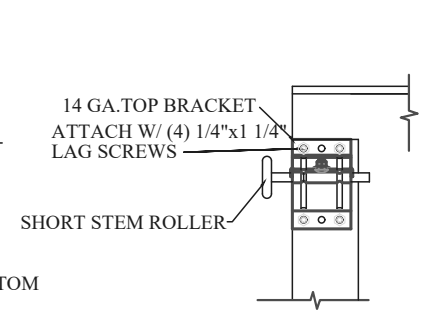

TOP BRACKET DETAIL
DETAIL 1/S1.1

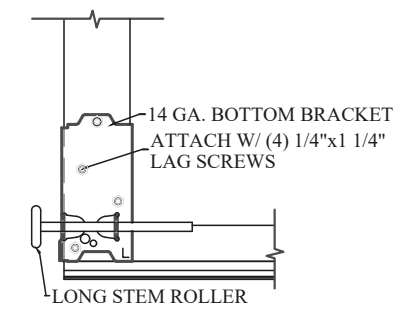

BOTTOM BRACKET DETAIL
DETAIL 2/S1.1

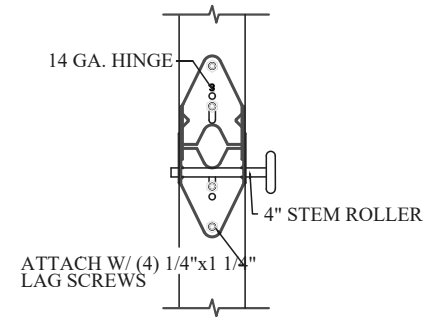

END HINGE DETAIL
DETAIL 3/S1.1

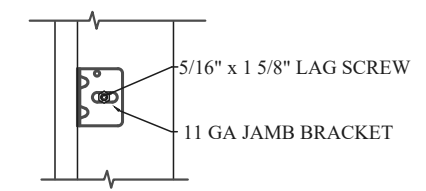

JAMB BRACKET DETAIL
DETAIL 5/S1.1

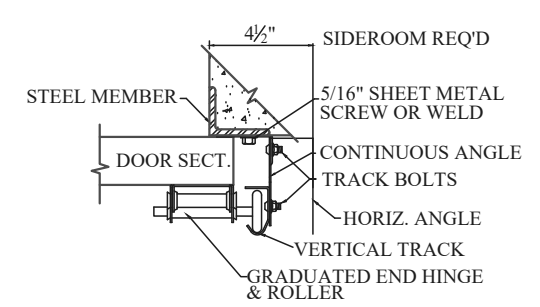

STEEL JAMB DETAIL (TYPICAL)
SECTION 'B-B'

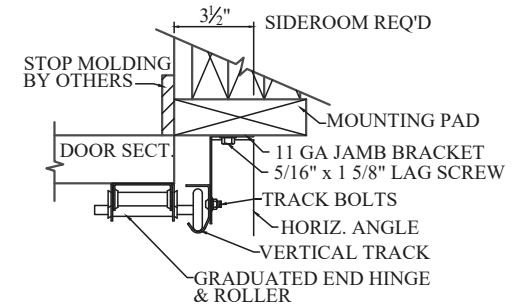

WOOD JAMB DETAIL (TYPICAL)
SECTION 'B-B'

MODELS: California, G-4400

DESIGN PRESSURE +12.4/-13.8 PSF
TEST PRESSURE +18.6/-20.7 PSF
TESTED PER THE APPLICABLE REQUIREMENTS OF:
ASTM: E 330 ANSI/DASMA 108-2017

NOTE: THE DESIGN OF SUPPORTING STRUCTURAL ELEMENTS SHALL BE THE RESPONSIBILITY OF THE PROFESSIONAL OF RECORD FOR THE BUILDING OR STRUCTURE IN ACCORDANCE WITH CURRENT BUILDING CODES

		ENGINEERING DRAWING	
TITLE			
18'2" MAX. WIDTH, WIND LOAD RATED DOOR			
MODEL	GARAGA California, G-4400	REV. NO.	0
SCALE	N/A	SHEET	OF
		DATE	10/17/23